

HID-Basic Semi-Parallel ballasts for MHN/CDM lamps

BMH 35 L302 ITS

The HID Basic Semi-Parallel ballast is an impregnated (HID standard) electromagnetic copper/iron ballast for use with an external ignitor for metal-halide and CDM lamps.

Product data

• General Characteristics

Application code	L302 ITS
Rated Ballast-Lamp Power	35
Line Voltage	230 V
Line Frequency	50 Hz

• Operating Characteristics

Mains voltage safety (AC)	-10%/+10%
Mains voltage performance (AC)	-8%/+6%
Input current with PF-correct.	0.24 A
Input current w/o PF-correct.	0.53 A
Power losses gear	8.1 W
PowerFactor 100% output power	0.85 (min) -
PowerFactor w/o PF compens.	0.40 -

• Wiring Characteristics

Connector type	Screw
----------------	-------

• Temperature Characteristics

T-winding maximum (tw)	130 (max) C
Delta-T normal conditions	55 C

• Product Dimensions

Length A1	117.0 mm
Fixing Hole Distance	102.0 mm
Length A2	
Width B1	57.1 mm
Height C1	51.5 mm
Fixing Hole Diameter D1	6.2 mm

• Approval & Application Chars

CE marking	Yes
ENEC certificate	No
CCC certificate	Yes

• Product Data

Order code	913710103150
Full product code	913710103150
Full product name	BMH 35 L302 ITS
Order product name	BMH 35 L302 ITS
Pieces per pack	1
Packing configuration	6
Packs per outerbox	6
Bar code on pack - EAN1	8710163148410
Bar code on outerbox - EAN3	8710163032368
Logistic code(s) - 12NC	913710103150
Net weight per piece	0.666 kg

PHILIPS

Dimensional drawing

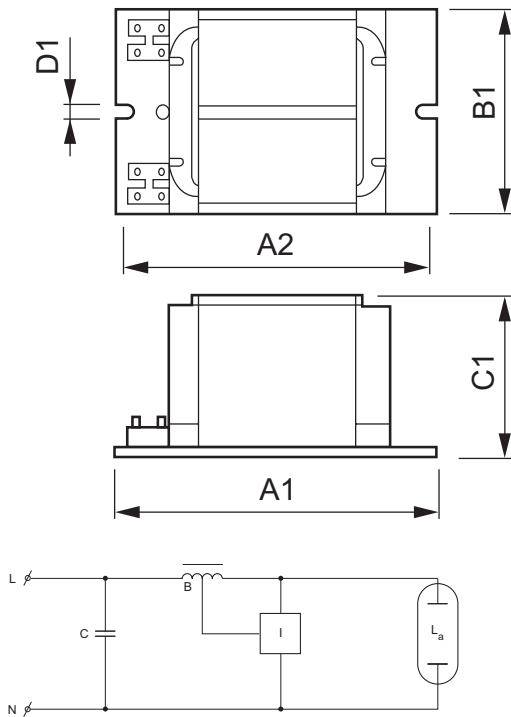

BMH 35 L302 ITS

Product	A1 (Norm)	A2 (Norm)	C1 (Norm)	D1 (Norm)	W (Norm)
BMH 35 L302 ITS	117.0	102.0	51.5	6.2	57.1



© 2014 Koninklijke Philips N.V. (Royal Philips)
All rights reserved.

Specifications are subject to change without notice. Trademarks are the property of Koninklijke Philips N.V. (Royal Philips) or their respective owners.

www.philips.com/lighting

2014, April 11
data subject to change